



THE GRANGE SCHOOL

# TRANSPORT SERVICE

2024 - 2025

# WELCOME

Dear Parents / Guardians,

Thank you for taking the time to look at The Grange School bus services for the 2024-2025 academic year. This is the second version of such a guide, which sets out the wide range of travel options available to the pupils at The Grange School.

We are delighted to continue our partnership with Vectare, a specialist school transport management company, to manage the school bus services. Vectare are responsible for over 2.5 million independent school journeys a year. Vectare will manage all aspects of the school's service, and any enquiries can be directed to their team at [grange.vectare.co.uk](https://grange.vectare.co.uk).

All bookings for school bus routes are made via our online booking system, which can be viewed at [grange.vectare.co.uk](https://grange.vectare.co.uk). This means that you no longer need to complete any paper forms. Payment for the service is made at the time of booking and your child's name will automatically be added to the register. The website also incorporates an interactive journey planner which allows you to enter your postcode and find your closest bus stop.

This guide provides an overview of the school bus service network and contains further details including fare and timetable information. All bookings for all routes can be made via the dedicated transport website.

The website allows you to book travel 24/7 from anywhere in the world, meaning that if you need to leave early for work one morning or you are running late and you would like your child to travel on a school bus as a one off, you can make a booking right up until the bus is due to depart.

Other amendments and changes can also be made via the **'my account'** section of the website.

If you need any further assistance, or you would like to discuss travel options from areas not currently served by our network, please contact us via the bookings website and we will be pleased to assist.

I would like to take this opportunity to wish your child a pleasant and successful academic year ahead.

Yours faithfully,

**Transport Team**



Scan the QR code  
to make a booking!

# HOW TO BOOK

grange.vectare.co.uk

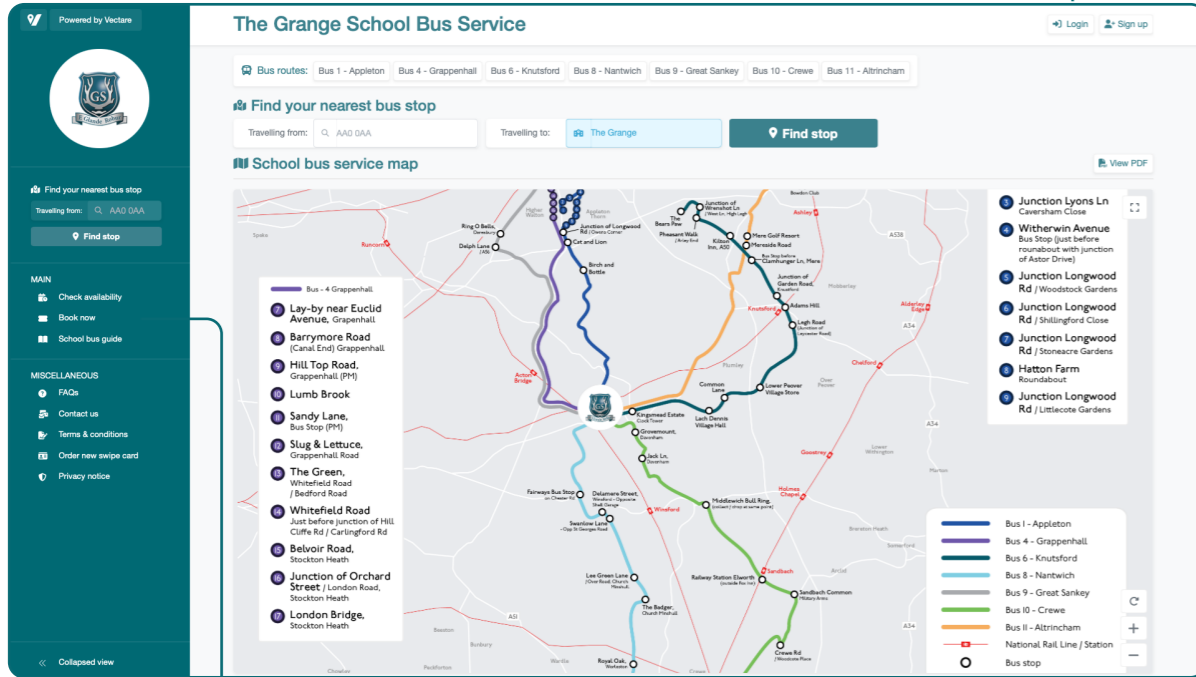

## 1 How do I sign in?

To sign up click the “Log in” button on the top-right of the website.

## 2 How do I make a booking?

To make a booking please click the “Book Now” button on the left-hand side of the website. Alternatively, if you type your postcode in under the “Find your nearest stop” banner on the top, you will be able to see all of your closest stops and click “Book Now” from here.

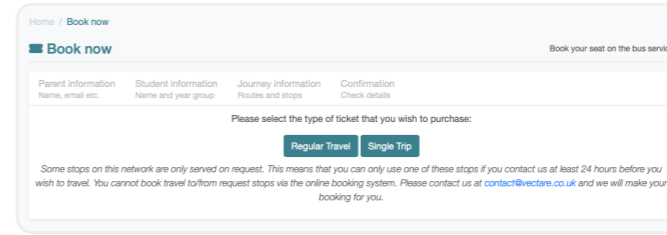

## 3 Booking / Payment

Simply fill out your information on our system once you have logged in.

Please ensure that your child arrives at the time of the booking as the bus will not wait after the departure time.



Apple App Store



Google App Store



VecTive Passenger app is available to download on the apple app store or google play store.

## Passenger App

Mark as **Not Travelling**

To avoid unnecessary delays, don't forget to remove your child from the journey list if they are not travelling on any given day. This is easy to do on the app.

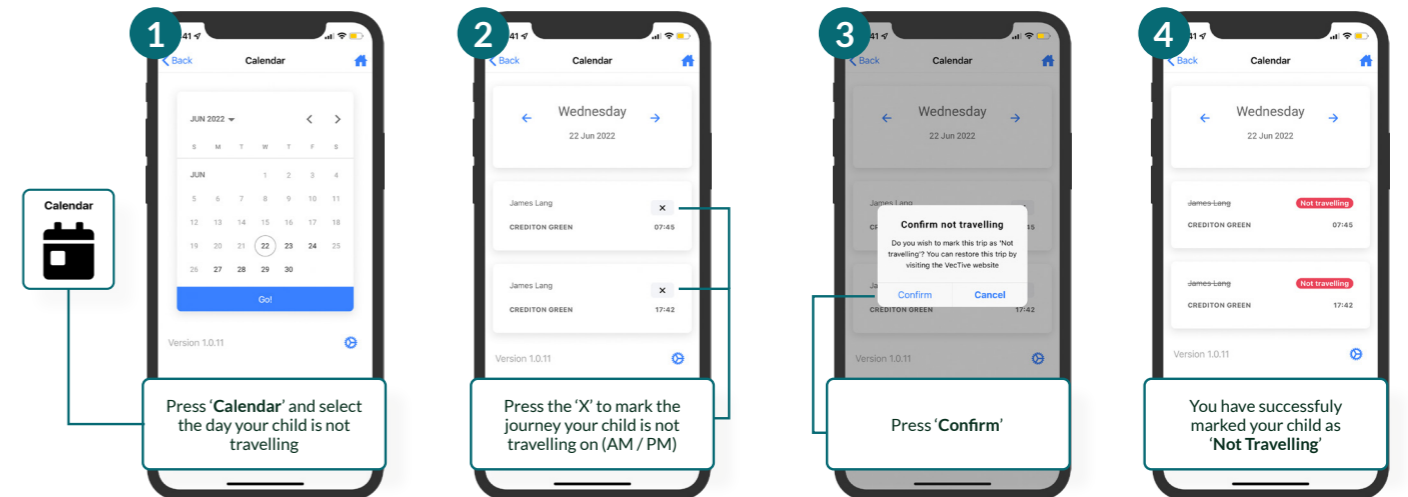

Press 'Calendar' and select the day your child is not travelling

Press the 'X' to mark the journey your child is not travelling on (AM / PM)

Press 'Confirm'

You have successfully marked your child as 'Not Travelling'

# ROUTE MAP

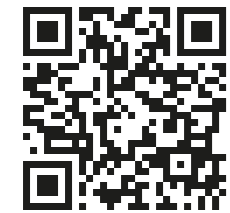

Scan the QR code to make a booking!

- Bus - 3 Frodsham
- 13 200 yards from Norley Rd, School
- 14 Sandiway Church, Lay-by
- 15 End of School Ln Just before junction of Norley Rd

- Bus - 4 Grappenhall
- 7 Lay-by near Euclid Avenue, Grappenhall
- 8 Barrymore Road (Canal End) Grappenhall
- 9 Hill Top Road, Grappenhall (PM)
- 10 Lumb Brook
- 11 Sandy Lane, Bus Stop (PM)
- 12 Slug & Lettuce, Grappenhall Road
- 13 The Green, Whitefield Road / Bedford Road
- 14 Whitefield Road Just before junction of Hill Cliffe Rd / Carlingford Rd
- 15 Belvoir Road, Stockton Heath
- 16 Junction of Orchard Street / London Road, Stockton Heath
- 17 London Bridge, Stockton Heath

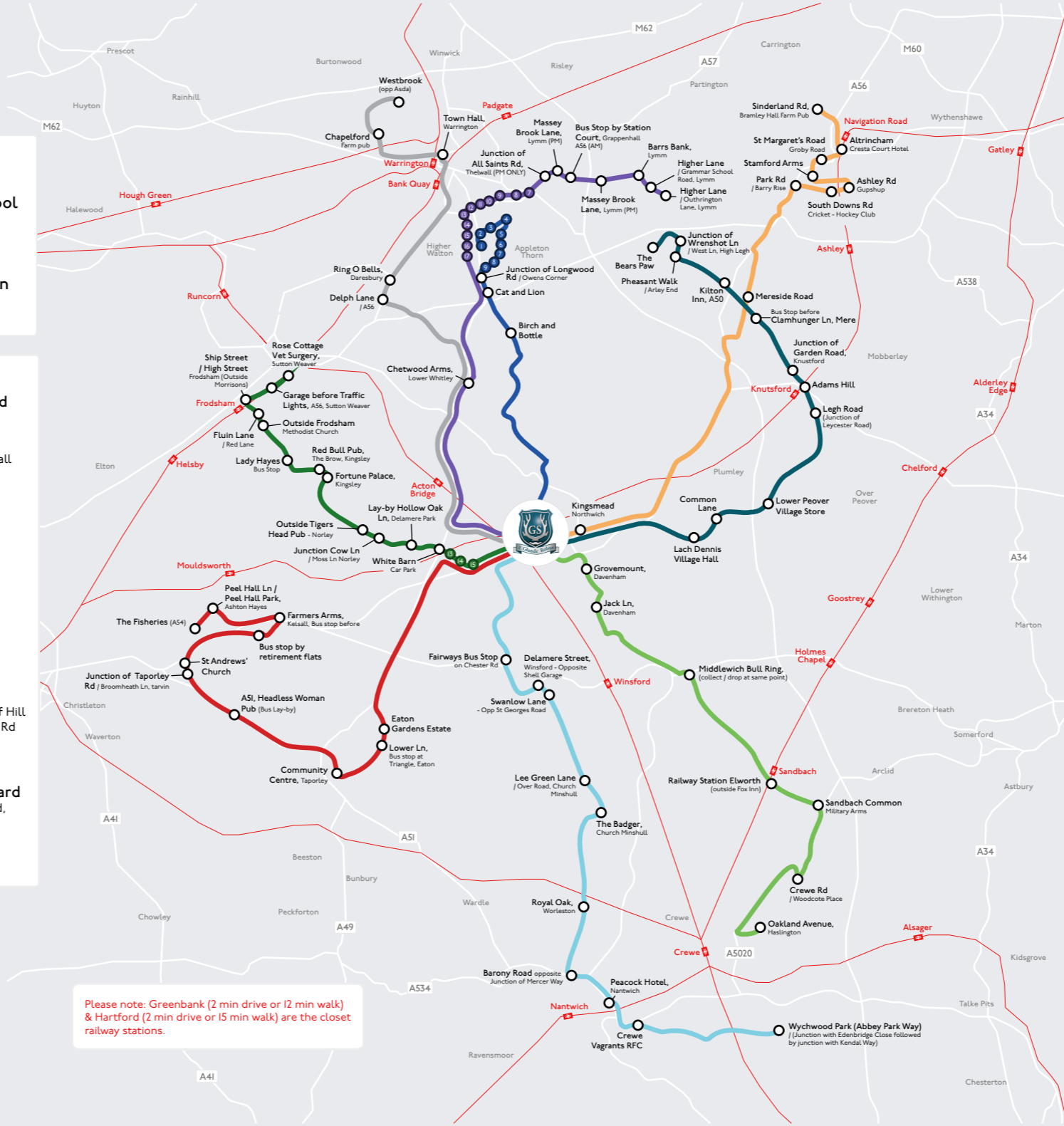

Please note: Greenbank (2 min drive or 12 min walk) & Hartford (2 min drive or 15 min walk) are the closest railway stations.

- Bus - 1 Appleton
- 1 Appleton Fairways
- 2 Just after the Junction of Lyons Lane / Park Crescent
- 3 Junction Lyons Ln Caversham Close
- 4 Witherwin Avenue Bus Stop (just before roundabout with junction of Astor Drive)
- 5 Junction Longwood Rd / Woodstock Gardens
- 6 Junction Longwood Rd / Shillingford Close
- 7 Junction Longwood Rd / Stoneacre Gardens
- 8 Hatton Farm Roundabout
- 9 Junction Longwood Rd / Littlecote Gardens

- Bus 1 - Appleton
- Bus 3 - Frodsham
- Bus 4 - Grappenhall
- Bus 5 - Kelsall & Taporley
- Bus 6 - Knutsford
- Bus 8 - Nantwich
- Bus 9 - Great Sankey
- Bus 10 - Crewe
- Bus 11 - Altrincham
- National Rail Line / Station
- Bus stop

A private service has been commissioned via parents by 'Kens of Congleton' for exclusive use by The Grange School students. This route covers Congleton, Brereton, Holmes Chapel, Cranage, Twemlow and Goostrey.  
For more details please contact the school on 01606 539010.

# TIMETABLE

## Bus 1 - Appleton - AM

Stops	AM (M-F)	Price - per journey
Appleton Fairways	07:40	£5.95
Just after the junction of Lyons Lane / Park Crescent	07:42	£5.95
Junction Lyons Lane / Caversham Close	07:44	£5.95
Witherwin Avenue Bus Stop (just before roundabout with junction of Astor Drive)	07:46	£5.95
Junction Longwood Road / Woodstock Gardens	07:47	£5.95
Junction Longwood Road / Shillingford Close	07:48	£5.95
Junction Longwood Road / Stoneacre Gardens	07:50	£5.95
Hatton Farm Roundabout	07:55	£5.40
Junction Longwood Road / Littlecote Gardens	08:00	£5.40
Junction of Longwood Road / Owens Corner	08:01	£5.40
Cat and Lion	08:02	£5.40
Comberbach Memorial Hall	08:12	£5.40
The Grange School	08:25	-

## Bus 1 - Appleton - PM

Stops	PM (M-F)	Price - per journey
The Grange School	16:05	-
Comberbach Memorial Hall	16:17	£5.40
Cat and Lion	16:25	£5.40
Junction of Longwood Road / Owens Corner	16:45	£5.40
Junction Longwood Road / Littlecote Gardens	16:44	£5.40
Hatton Farm Roundabout	16:40	£5.40
Junction Longwood Road / Stoneacre Gardens	16:42	£5.95
Junction Longwood Road / Shillingford Close	16:38	£5.95
Junction Longwood Road / Woodstock Gardens	16:36	£5.95
Witherwin Avenue Bus Stop (just before roundabout with junction of Astor Drive)	16:35	£5.95
Junction Lyons Lane / Caversham Close	16:34	£5.95
Just after the junction of Lyons Lane / Park Crescent	16:32	£5.95
Appleton Fairways	16:30	£5.95

1

Scan the QR code or go to [grange.vectare.co.uk](https://grange.vectare.co.uk) to locate your nearest stop and book travel.



2

Make your booking and receive instant confirmation.

3

Contact Vectare via the website if you have any questions.

## Bus 3 - Frodsham - AM

Stops	AM (M-F)	Price - per journey
Garage before traffic Lights, A56, Sutton Weaver	07:45	£5.95
Rose Cottage Vet Surgery, Sutton Weaver	07:47	£5.95
Ship Street / High Street, Frodsham (Outside Morrisons)	07:50	£5.95
Fluin Lane / Red Lane	07:52	£5.95
Outside Frodsham Methodist Church	07:55	£5.95
Lady Hayes Bus Stop	07:57	£5.95
Red Bull Pub, The Brow, Kingsley	08:00	£5.95
Fortune Palace, Kingsley	08:03	£5.95
End of School Ln - Just before junction of Norley Rd	08:05	£5.40
Outside Tigers Head Pub - Norley	08:08	£5.40
Junction Cow Ln / Moss Ln Norley	08:11	£5.40
Lay-by Hollow Oak Ln, Delamere Park	08:14	£4.40
White Barn Car Park	08:16	£3.75
200 yards from Norley Road, School	08:18	£3.75
Sandiway Church, Lay-by	08:19	£3.75
The Grange School	08:25	-

## Bus 3 - Frodsham - PM

Stops	PM (M-F)	Price - per journey
The Grange School	16:05	-
Sandiway Church, Lay-by	16:15	£3.75
200 yards from Norley Road, School	16:16	£3.75
White Barn Car Park	16:18	£3.75
Lay-by Hollow Oak Ln, Delamere Park	16:20	£4.40
Junction Cow Ln / Moss Ln Norley	16:23	£5.40
Outside Tigers Head Pub - Norley	16:25	£5.40
End of School Ln - Just before junction of Norley Rd	16:28	£5.40
Fortune Palace, Kingsley	16:30	£5.95
Red Bull Pub, The Brow, Kingsley	16:33	£5.95
Lady Hayes Bus Stop	16:36	£5.95
Outside Frodsham Methodist Church	16:38	£5.95
Fluin Lane / Red Lane	16:40	£5.95
Ship Street / High Street, Frodsham (Outside Morrisons)	16:43	£5.95
Rose Cottage Vet Surgery, Sutton Weaver	16:45	£5.95
Garage before traffic Lights, A56, Sutton Weaver	16:48	£5.95

## Bus 4 - Grappenhall - AM

Stops	AM (M-F)	Price - per journey
Higher Lane / Oughtrington Lane, Lymm	07:25	£6.00
Higher Lane / Grammar School Road, Lymm	07:27	£6.00
Barrs Bank, Lymm	07:29	£6.00
Bus Stop by Station Court, Grappenhall A56 (AM)	07:33	£6.00
Lay-by near Euclid Avenue, Grappenhall	07:35	£6.00
Barrymore Road (Canal End) Grappenhall	07:36	£6.00
Hill Top Road, Grappenhall	07:38	£6.00
Lumb Brook	07:40	£6.00
Slug & Lettuce, Grappenhall Road	07:41	£6.00
The Green, Whitefield Road / Bedford Road	07:42	£6.00
Whitefield Road - Just before Junction of Hill Cliffe Road / Carlingford Road	07:44	£6.00
Belvoir Road, Stockton Heath	07:45	£6.00
Junction of Orchard Street / London Road, Stockton Heath	07:46	£6.00
London Bridge, Stockton Heath	07:48	£6.00
Chetwode Arms, Lower Whitley	08:00	£6.00
The Grange School	08:25	-

## Bus 4 - Grappenhall - PM

Stops (AM / PM)	PM (M-F)	Price - per journey
The Grange School	16:05	-
Chetwode Arms, Lower Whitley	16:18	£6.00
London Bridge, Stockton Heath	16:25	£6.00
Junction of Orchard Street / London Road, Stockton Heath	16:28	£6.00
Belvoir Road, Stockton Heath	16:35	£6.00
Whitefield Road - Just before Junction of Hill Cliffe Road / Carlingford Road	16:33	£6.00
The Green, Whitefield Road / Bedford Road	16:30	£6.00
Slug & Lettuce, Grappenhall Road	16:27	£6.00
Sandy Lane Bus Stop (PM)	16:37	£6.00
Lumb Brook	16:38	£6.00
Hill Top Road, Grappenhall	16:40	£6.00
Lay-by near Euclid Avenue, Grappenhall	16:45	£6.00
Junction of All Saints Road, Thelwall (PM ONLY)	16:47	£6.00
Massey Brook Lane, Lymm (PM)	16:49	£6.00
Barrs Bank, Lymm	16:50	£6.00
Higher Lane / Grammar School Road, Lymm	16:53	£6.00
Higher Lane / Oughtrington Lane, Lymm	16:55	£6.00

1

Scan the QR code or go to [grange.vectare.co.uk](https://grange.vectare.co.uk) to locate your nearest stop and book travel.



2

Make your booking and receive instant confirmation.

3

Contact Vectare via the website if you have any questions.

## Bus 5 - Kelsall & Taporley - AM

Stops	AM (M-F)	Price - per journey
The Fisheries (A54)	07:25	£6.25
Peel Hall Lane / Peel Hall Park, Ashton Hayes	07:29	£6.25
Farmers Arms, Kelsall, Bus stop before	07:35	£5.75
Bus stop by retirement flats	07:37	£5.75
St Andrew's Church	07:43	£5.75
Junction of Taporley Road / Broomheath Lane, Tarvin	07:45	£5.75
A51, Headless Woman Pub (Bus Lay-by)	07:50	£5.40
Community Centre, Taporley	07:57	£5.40
Lower Lane, Bus stop at Triangle, Eaton	08:05	£5.40
Eaton Gardens Estate	08:06	£5.40
The Grange School	08:25	-

## Bus 5 - Kelsall & Taporley - PM

Stops	PM (M-F)	Price - per journey
The Grange School	16:05	-
Lower Lane, Bus stop at Triangle, Eaton	16:25	£5.40
Community Centre, Taporley	16:30	£5.40
A51, Headless Woman Pub (Bus Lay-by)	16:37	£5.40
Junction of Taporley Road / Broomheath Lane, Tarvin	16:40	£5.75
St Andrew's Church	16:42	£5.75
Bus stop by retirement flats	16:55	£5.75
Farmers Arms, Kelsall, Bus stop before	17:00	£5.75
Peel Hall Lane / Peel Hall Park, Ashton Hayes	16:50	£6.25
The Fisheries (A54)	16:47	£6.25



Scan the QR code to make a booking!



## Bus 6 - Knutsford - AM

Stops	AM (M-F)	Price - per journey
The Bears Paw	07:25	£5.90
Junction of Wrenshot Lane / West Lane, High Legh	07:30	£5.90
Pheasant Walk / Arley End	07:31	£5.90
Kilton Inn, A50	07:34	£5.90
Junction of Garden Road, Knutsford	07:44	£5.90
Adams Hill	07:46	£5.90
Legh Road (Junction of Parkfield Road)	07:55	£5.90
Lower Peover Village Store	08:05	£5.40
Common Lane	08:07	£5.40
Lach Dennis Village Hall	08:10	£4.60
The Grange School	08:25	-

## Bus 6 - Knutsford - PM

Stops	PM (M-F)	Price - per journey
The Grange School	16:05	-
Kingsmead Northwich	16:15	£3.25
Lach Dennis Village Hall	16:20	£4.60
Common Lane	16:22	£5.40
Lower Peover Village Store	16:25	£5.40
Legh Road (Junction of Parkfield Road)	16:35	£5.90
Adams Hill	16:36	£5.90
Junction of Garden Road, Knutsford	16:37	£5.90
Bus Stop before Clamhunger Lane, Mere	16:40	£5.90
Kilton Inn, A50	16:43	£5.90
Pheasant Walk / Arley End	16:45	£5.90
Junction of Wrenshot Lane / West Lane, High Legh	16:50	£5.90
The Bears Paw	16:55	£5.90

1

Scan the QR code or go to [grange.vectare.co.uk](https://grange.vectare.co.uk) to locate your nearest stop and book travel.



2

Make your booking and receive instant confirmation.

3

Contact Vectare via the website if you have any questions.

## Bus 8 - Nantwich - AM

Stops	AM (M-F)	Price - per journey
Wychwood Park (Abbey Park Way) / (Junction with Edenbridge Close followed by junction with Kendal Way)	07:25	£6.25
Crewe Vagrants RFC	07:35	£6.25
Peacock Hotel, Nantwich	07:40	£6.25
Barony Road opposite Junction of Mercer Way	07:45	£6.25
Royal Oak, Worleston	07:50	£6.25
The Badger, Church Minshull	07:55	£6.25
Lee Green Lane / Over Road, Church Minshull	07:57	£6.25
Swanlow Lane - Opp St George's Road	08:02	£5.55
Delamere Street, Winsford - Opposite Shell Garage	08:05	£5.55
Fairways Bus Stop on Chester Road	08:06	£5.55
The Grange School	08:25	-

## Bus 8 - Nantwich - PM

Stops	PM (M-F)	Price - per journey
The Grange School	16:05	-
Fairways Bus Stop on Chester Road	16:16	£5.55
Delamere Street, Winsford - Opposite Shell Garage	16:20	£5.55
Swanlow Lane - Opp St George's Road	16:23	£5.55
The Old Star Pub, Swanlow Lane	16:24	£5.55
Lee Green Lane / Over Road, Church Minshull	16:28	£6.25
The Badger, Church Minshull	16:30	£6.25
Royal Oak, Worleston	16:35	£6.25
Barony Road opposite Junction of Mercer Way	16:40	£6.25
Peacock Hotel, Nantwich	16:45	£6.25
Crewe Vagrants RFC	16:50	£6.25
Wychwood Park (Abbey Park Way) / (Junction with Edenbridge Close followed by junction with Kendal Way)	17:05	£6.25

1

Scan the QR code or go to [grange.vectare.co.uk](https://grange.vectare.co.uk) to locate your nearest stop and book travel.



2

Make your booking and receive instant confirmation.

3

Contact Vectare via the website if you have any questions.

### Bus 9 - Great Sankey - AM

Stops	AM (M-F)	Price - per journey
Westbrook (opp Asda)	07:20	£6.40
Chapelford Farm pub	07:30	£6.40
Town Hall, Warrington	07:40	£5.40
Ring O' Bells, Daresbury	07:55	£5.40
Delph Lane / A56	07:58	£5.10
The Grange School	08:25	-

### Bus 9 - Great Sankey - PM

Stops	PM (M-F)	Price - per journey
The Grange School	16:05	-
Delph Lane / A56	16:30	£5.10
Ring O' Bells, Daresbury	16:34	£5.40
Town Hall, Warrington	16:45	£5.40
Chapelford Farm pub	16:55	£6.40
Westbrook (opp Asda)	17:00	£6.40

1

Scan the QR code or go to [grange.vectare.co.uk](http://grange.vectare.co.uk) to locate your nearest stop and book travel.



2

Make your booking and receive instant confirmation.

3

Contact Vectare via the website if you have any questions.

### Bus 10 - Crewe - AM

Stops	AM (M-F)	Price - per journey
Crewe Road/ Woodcote Place	07:45	£6.55
Sandbach Common Military Arms	07:55	£6.55
Railway Station Elworth (outside Fox Inn)	08:00	£6.55
Middlewich Bull Ring, (collect / drop at same point)	08:10	£6.55
Jack Lane, Davenham	08:22	£3.25
Grovemount, Davenham	08:24	£3.25
The Grange School	08:25	-

### Bus 10 - Crewe - PM

Stops	PM (M-F)	Price - per journey
The Grange School	16:05	-
Grovemount, Davenham	16:15	£3.25
Jack Lane, Davenham	16:17	£3.25
Middlewich Bull Ring, (collect / drop at same point)	16:30	£6.55
Railway Station Elworth (outside Fox Inn)	16:40	£6.55
Sandbach Common Military Arms	16:45	£6.55
Crewe Road/ Woodcote Place	16:55	£6.55
Oakland Avenue, Haslington	17:00	£6.55

### Bus 11 - Altrincham - AM

Stops	AM (M-F)	Price - per journey
Sinderland Road, Bramley Hall Farm Pub	07:25	£5.00
Altrincham Cresta Court Hotel	07:30	£5.00
St Margaret's Road - Groby Road	07:35	£5.00
Stamford Arms	07:37	£5.00
Ashley Road Bus Stop Outside Gupshup	07:43	£5.00
South Downs Road - Cricket - Hockey Club	07:45	£5.00
Park Road / Barry Rise	07:52	£5.00
Mereside Road	08:00	£5.00
Kingsmead Northwich	08:20	£3.25
The Grange School	08:25	-

### Bus 11 - Altrincham - PM

Stops	PM (M-F)	Price - per journey
The Grange School	16:05	-
Mereside Road	16:25	£5.00
St Margaret's Road - Groby Road	16:40	£5.00
Stamford Arms	16:42	£5.00
Ashley Road Bus Stop opp. Gupshup	16:45	£5.00
South Downs Road - Cricket - Hockey Club	16:50	£5.00
Park Road / Barry Rise	16:55	£5.00
Altrincham Cresta Court Hotel	17:00	£5.00
Sinderland Road, Bramley Farm Pub	17:05	£5.00

The Altrincham route is a new, in-house operated route in which pupils pay for all 10 journeys per week. This is reflected in the price point and is specific for this route only, The logistics of the operation of this route is subject to regular review.





Scan the QR code  
to make a booking!

# TERMS & CONDITIONS

1. This agreement is made between all school bus passengers, their parents and The Grange School in order to provide safe, comfortable and civilised journeys for all passengers.
2. Arrangements for pupils' journeys to and from the school are the responsibility of their parents. To assist with discharging this responsibility, The Grange School provides a school bus service.
3. Transport on the school bus service must be arranged in advance and is paid for through the online booking system. If you wish to use the school bus service on an ad hoc basis, or to vary the details of their bus travel as a one-off, you should book travel via the website prior to travel.
4. Bookings on the school bus service are non-refundable in the event of a pupil failing to travel.
5. Bookings are to be made online via [grange.vectare.co.uk](https://grange.vectare.co.uk).
6. It will be the parents' responsibility to inform the school via the '[Contact Us](#)' form on the website if they no longer wish to use the school bus service. Half a school term's notice must be given by a parent prior to the removal of a pupil from the school Transport Service (apart from an ad-hoc journey). If an ad hoc journey is cancelled with more than 24 hours' notice the booking can be transferred to another journey. The cancellation can be made on the system but parents need to contact Vectare to apply the booking to a future date.
7. No pupil is permitted to travel on the school bus service if not pre-booked for that bus. Other arrangements for journeys to and from school must be made by them or their parents.
8. Pupils must travel to and from The Grange School in full school uniform or a full school PE kit (except on approved non-uniform days).
9. Pupils should be at the bus stop five minutes before the scheduled time of departure to ensure they don't miss the service. In the evening, parents should be at the bus stop five minutes before the scheduled time of arrival to collect a passenger.
10. Good conduct is required at all times. Bullying, shouting, use of foul language, dropping litter, eating, playing music, or any other misbehaviour is strictly forbidden.
11. Except when embarking or disembarking, all passengers must remain seated with their seatbelts fastened correctly.
12. Whilst on a school bus, all passengers must accept without question the authority of a transport company official or school member or staff who may ask them to obey any reasonable instruction such as to pick up litter, desist from certain actions or to move to a different seat.
13. Failure to comply with these conditions may result in disciplinary action, including temporary or permanent withdrawal of permission to use the school bus service.
14. The Grange School aims for 95% of journeys to operate within the transport industry window of tolerance of one minute early to five minutes late, however timings may vary due to traffic conditions or unforeseen circumstances. Drivers will not wait past the scheduled departure time.
15. Pupils must be in reception or above to travel on the school bus service.



# THE GRANGE SCHOOL

Produced by Vectare for The Grange School. © Vectare 2025. Timetable, route and fare information is correct as of January 2025.

This guide is produced for information only. We cannot be held liable for any errors or omissions or for any loss or damages caused, howsoever arising and including consequential losses, as a result of the use of this guide. Please note that bus routes are subject to change.